

Setting the Pattern

The HRX 075 Rotor can be set to rotate between 40° and 360°. The rotor is preset at 180°.

Align the right edge:

Turn the top of the head all the way to the left until it stops and then all the way to the right. This is the starting point for the rotation.

To increase or decrease the rotation:

Insert the plastic end of the key into the pattern adjustment slot. Turn clockwise to increase rotation; turn counterclockwise to decrease rotation.

Each full turn increases/decreases rotation by 90°.

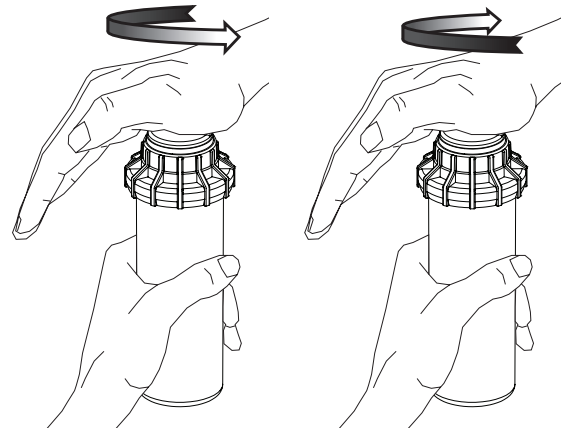

Setting the Spray Distance

Set the spray distance with water on under system's normal operating pressure.

Insert the hex (metal) end of the key into the distance adjustment slot.

Turn clockwise to decrease distance; turn counterclockwise to increase distance.

Caution: DO NOT turn the adjustment screw too far in either direction—screw may come free of threads.

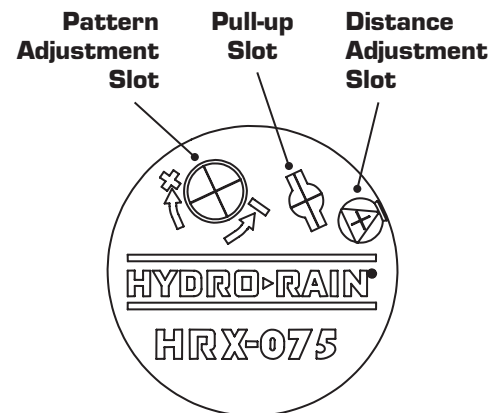

Removing and Replacing the Nozzle

To access the nozzle:

Insert the plastic end of the key into the pull-up slot.

Turn the key 90° and pull upward.

Firmly grip the sprinkler stem. Note: The spring inside the canister is very strong.

Removing the nozzle:

Insert the hex (metal) end of the key into the distance adjustment slot. Turn the screw counterclockwise until it is just clear of the nozzle.

Caution: DO NOT turn the adjustment screw too far in either direction—screw may come free of threads.

The nozzle can then be removed by prying outward under the nozzle.

Replacing the nozzle:

Insert the desired replacement nozzle and align vertically.

Turn the screw back into place.

Gently release the sprinkler stem back into the canister.

